

6.1 Conveyor Chains, DIN 8165

Conveyor chains with solid pins Type FV DIN 8165 part 1 Sheet 1/2
Single-strand chains

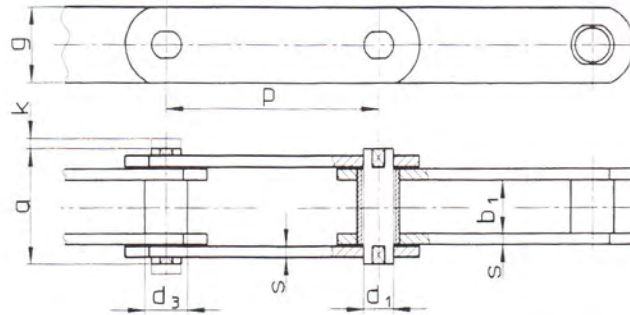

DIN number of chain	Pitch p	Inside width b ₁	Pins ∅ d ₁	Bushes ∅ d ₃	Small rollers ∅ d ₄	Rollers ∅ d ₅	Flanged rollers ∅ d ₆ /d ₇	Link plate width g	Link plate thickness s
FV 40	40 63 100	18	10	15	20	32	40/48	26	3
FV 63	63 100 125 160	22	12	18	26	40	50/60	30	4
FV 90	63 100 125 160 200 250	25	14	20	30	48	63/73	35	5
FV 112	100 125 160 200 250	30	16	22	32	55	72/87	40	6
FV 140	100 125 160 200 250 315	35	18	26	36	60	80/95	45	6
FV 180	125 160 200 250 315 400	45	20	30	42	70	100/120	50	8
FV 250	125 160 200 250 315 400	55	26	36	50	80	125/145	60	8
FV 315	160 200 250 315 400	65	30	42	60	90	140/170	70	10
FV 400	160 200 250 315 400	70	32	44	60	100	150/185	70	12
FV 500	160 200 250 315 400 500	80	36	50	70	110	160/195	80	12
FV 630	200 250 315 400 500	90	42	56	80	120	170/210	100	12

Conveyor chains with solid pins
 Single-strand chains

Type FV

DIN 8165 part 1

Sheet 2/2

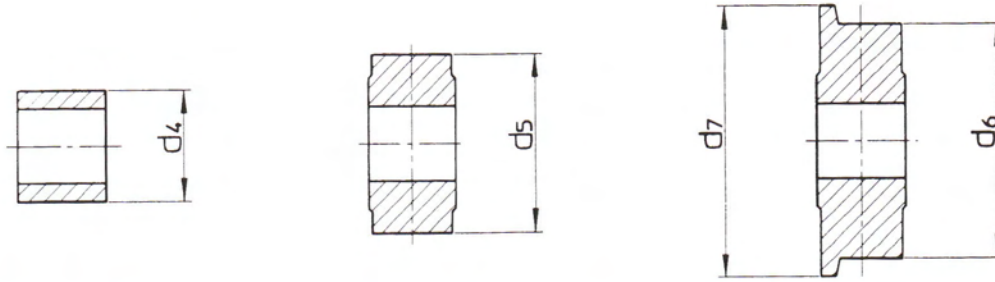

DIN number of chain	Max. rivet pin length a	Max. projection of closing pin k	Breaking load	Articulation surface	Admissible articulation surface pressure	Weight of chain			
						without roller	with small roller	with large roller	with flanged roller
						kg/m			
FV 40	37	3,5	40	2,5	2680	2,70	3,13	4,71	-
						2,16	2,43	3,44	4,62
						1,82	1,99	2,62	3,37
FV 63	46	4,5	63	3,7	2840	3,52	4,21	6,04	8,35
						2,91	3,35	4,50	5,96
						2,71	3,06	3,98	5,14
						2,53	2,80	3,52	4,43
FV 90	53	4,5	90	5,0	3000	5,28	6,42	9,61	-
						4,34	5,06	7,07	9,87
						4,03	4,60	6,21	8,44
						3,75	4,19	5,45	7,20
						3,55	3,90	4,91	6,31
						3,39	3,67	4,48	5,59
FV 112	63	4,5	112	6,8	2750	6,17	7,11	10,60	15,28
						5,69	6,44	9,23	12,98
						5,27	5,86	8,04	10,96
						4,97	5,44	7,18	9,53
						4,73	5,10	6,50	8,37
FV 140	68	6,0	140	8,6	2720	7,61	8,87	13,50	20,16
						6,94	7,94	11,65	16,97
						6,35	7,13	10,03	14,19
						5,92	6,55	8,87	12,20
						5,59	6,09	7,95	10,61
						5,31	5,71	7,18	9,29
FV 180	86	7,0	180	12,3	2440	10,78	12,61	19,18	31,44
						9,80	11,23	16,36	25,94
						9,09	10,24	14,34	22,01
						8,53	9,45	12,73	18,86
						8,07	8,79	11,40	16,27
						7,69	8,26	10,31	14,14
FV 250	98	8,0	250	18,7	2230	14,78	17,92	27,75	-
						13,19	15,65	23,33	43,09
						12,06	14,03	20,17	35,98
						11,16	12,73	17,65	30,29
						10,41	11,66	15,56	25,60
						9,80	10,78	13,85	21,76
FV 315	117	8,0	315	25,8	2040	20,38	24,84	35,44	-
						18,50	22,07	30,55	55,02
						17,00	19,85	26,64	46,21
						15,76	18,02	23,41	38,94
						14,75	16,53	20,77	33,00
FV 400	131	10,0	400	30,7	2170	24,27	28,62	44,46	-
						22,05	25,53	38,21	67,95
						20,28	23,06	33,20	57,00
						18,81	21,02	29,07	47,96
						17,62	19,36	25,70	40,57
FV 500	141	10,0	500	38,2	2180	30,40	37,61	57,75	-
						27,34	33,11	49,21	85,71
						24,88	29,50	42,38	71,59
						22,86	26,52	36,75	59,92
						21,20	24,09	32,14	50,39
						19,98	22,29	28,73	43,33
FV 630	153	10,0	630	48,7	2160	36,96	45,82	66,24	-
						33,34	40,42	56,76	92,74
						30,34	35,97	48,93	77,49
						27,90	32,33	42,54	65,03
						26,09	29,63	37,80	55,79

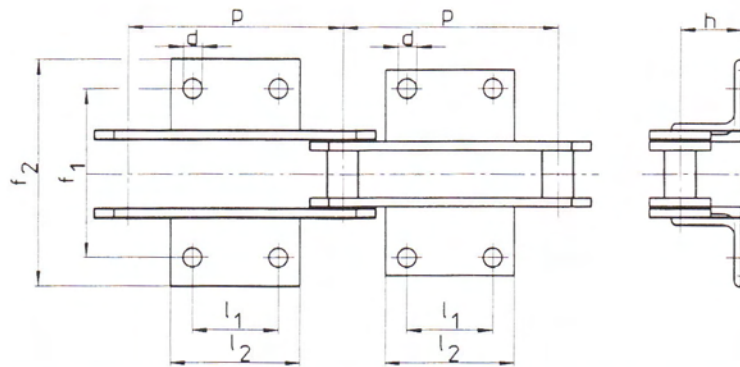

DIN number of chain	Pitch	Length of bracket	Hole pitch	Hole	Distance between hole centres	Overall width of chain	Height above chain centre	Bracket DIN 1028
	p	l ₂	l ₁	∅ d	f ₁	f ₂ (max)	h	
mm								
FV 40	63	31	-	6,6	50	100	20	25x25x3
	100	50	30					
FV 63	63	40	-	9,0	68	110	30	30x30x3
	100	50	30					
	125	60	40					
	160	70	50					
FV 90	100	50	30	9,0	80	130	35	40x40x4
	125	60	40					
	160	70	50					
	200	80	60					
	250	85	65					
FV 112	100	50	30	11,0	100	140	40	40x40x5
	125	65	40					
	160	75	50					
	200	90	65					
	250	105	80					
FV 140	100	55	30	11,0	100	170	45	50x50x5
	125	65	40					
	160	75	50					
	200	90	65					
	250	105	80					
	315	125	100					
FV 180	125	65	35	13,5	128	190	45	50x50x6
	160	80	50					
	200	95	65					
	250	110	80					
	315	130	100					
	400	130	100					
FV 250	125	50	-	13,5	138	230	55	65x65x7
	160	80	50					
	200	95	65					
	250	110	80					
	315	130	100					
	400	130	100					
FV 315	160	50	-	13,5	170	260	60	70x70x9
	200	95	65					
	250	110	80					
	315	130	100					
	400	130	100					
FV 400	160	50	-	17,5	190	290	65	80x80x10
	200	100	60					
	250	120	80					
	315	140	100					
	400	140	100					
FV 500	160	50	-	17,5	200	300	70	80x80x10
	200	90	50					
	250	120	80					
	315	140	100					
	400	140	100					
	500	140	100					
FV 630	200	50	-	17,5	230	350	80	100x100x10
	250	110	70					
	315	140	100					
	400	140	100					
	500	140	100					

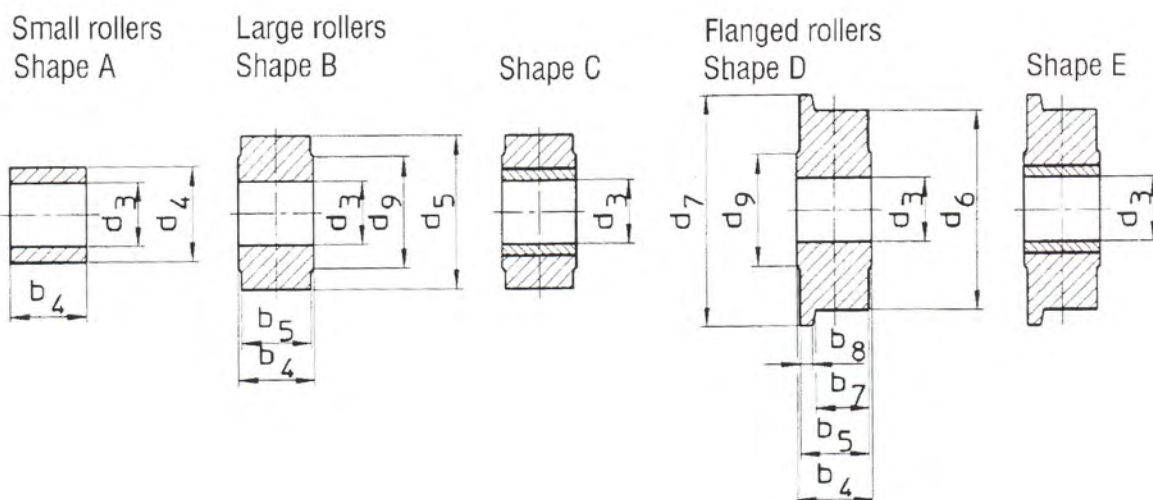

DIN number of chain	Width				Diameter							Weight	
	b ₄ max.	b ₅ max.	b ₇ max.	b ₈ max.	d ₃ max.	d ₄ max.	d ₅ max.	d ₆ max.	d ₇ max.	d ₉ =	Roller	Flanged roller	
	mm										kg		
FV 40	17	16	12,0	3,0	15,1	20	32	40	48	26	0,081	0,167	
FV 63	21	20	15,0	4,0	18,1	26	40	50	60	30	0,160	0,322	
FV 90	24	23	18,0	4,0	20,1	30	48	63	73	35	0,274	0,579	
FV 112	29	28	21,5	5,0	22,2	32	55	72	87	40	0,444	0,946	
FV 140	34	32	25,0	5,5	26,2	36	60	80	95	45	0,591	1,349	
FV 180	44	42	34,0	6,5	30,2	42	70	100	120	50	1,052	2,732	
FV 250	54	50	40,0	8,0	36,2	50	80	125	145	60	1,625	5,259	
FV 315	64	60	48,0	10,0	42,2	60	90	140	170	70	2,415	7,950	
FV 400	68	64	52,0	10,0	44,2	60	100	150	185	70	3,248	9,732	
FV 500	78	72	57,0	12,0	50,2	70	110	160	195	80	4,396	12,733	
FV 630	88	80	62,0	14,0	56,2	80	120	170	210	100	5,882	16,575	

Conveyor chains with solid pins
 Double-strand chains

Type FV

DIN 8165 part 1

Sheet 1/2

without rollers

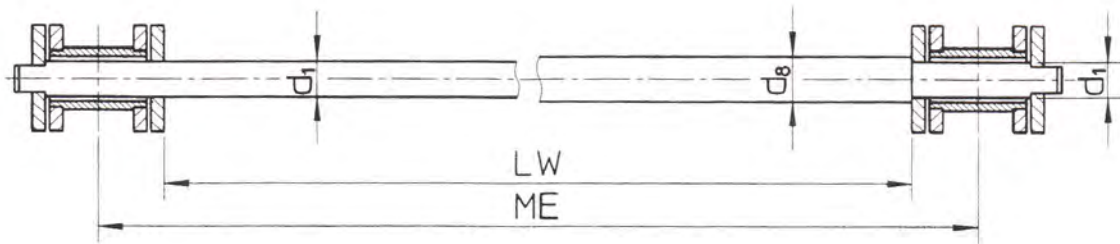

with small rollers of form A according to DIN 8166

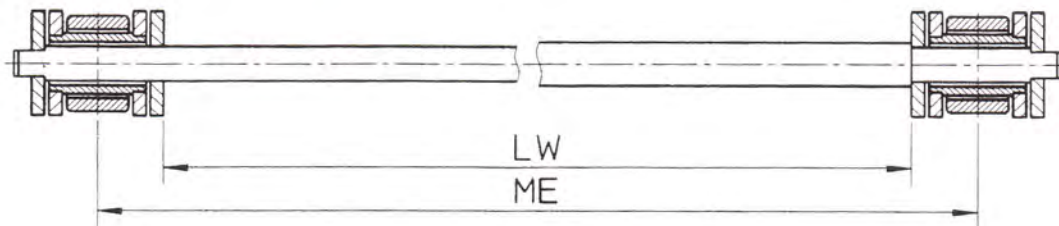

DIN number of chain	Sp	Track width mm							
		250	315	400	500	630	800	1000	1250
FV 40	ME	256	321	406	506	636	---	---	---
	LW	225	290	375	475	605	---	---	---
FV 63	ME	257	322	407	507	637	807	---	---
	LW	218	283	368	468	598	768	---	---
FV 90	ME	259	324	409	509	639	809	1009	---
	LW	213	278	363	463	593	763	963	---
FV 112	ME	260	325	410	510	640	810	1010	1260
	LW	205	270	355	455	585	755	955	1205
FV 140	ME	262	327	412	512	642	812	1012	1262
	LW	202	267	352	452	582	752	952	1202
FV 180	ME	270	335	420	520	650	820	1020	1270
	LW	191,5	256,5	341,5	441,5	571,5	741,5	941,5	1191,5
FV 250	ME	273	338	423	523	653	823	1023	1273
	LW	184	249	334	434	564	734	934	1184
FV 315	ME	279	344	429	529	659	829	1029	1279
	LW	172	237	322	422	552	722	922	1172
FV 400	ME	---	348	433	533	663	833	1033	1283
	LW	---	227	312	412	542	712	912	1162
FV 500	ME	---	350	435	535	665	835	1035	1285
	LW	---	219	304	404	534	704	904	1154
FV 630	ME	---	---	435	535	665	835	1035	1285
	LW	---	---	294	394	524	694	894	1144

Conveyor chains with solid pins
 Double-strand chains

Type FV

DIN 8165 part 1

Sheet 2/2

with runners of form B and C according to DIN 8166

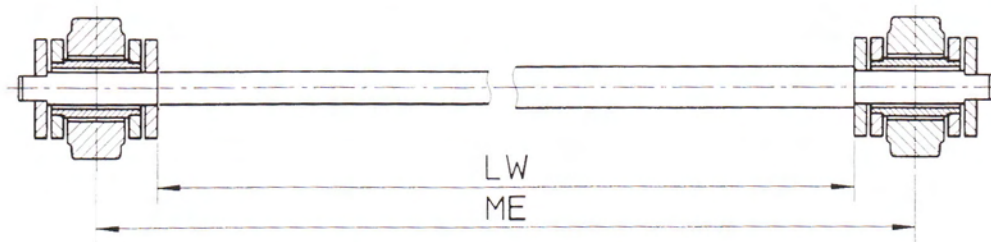

with flanged runners of form D and E according to DIN 8166

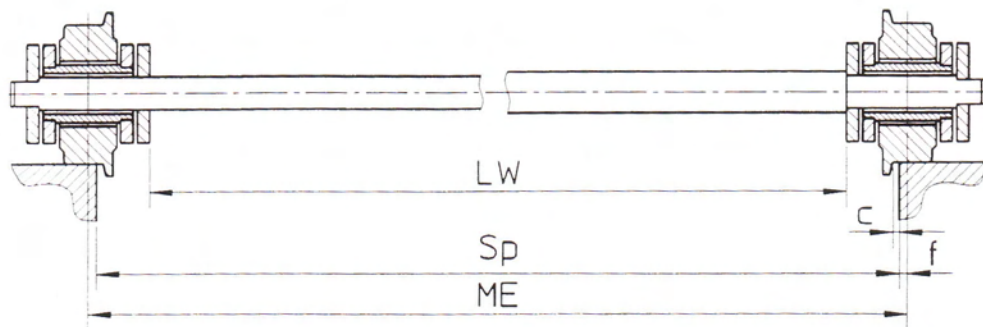

DIN number of chain		Track width mm					c mm	f mm	Axis \emptyset	Axis \emptyset
		Sp	1400	1600	1800	2000			d_1 mm	d_8 mm
FV 40	ME						1,0	3,0	10	15
	LW									
FV 63	ME						1,5	3,5	12	18
	LW									
FV 90	ME						2,0	4,5	14	20
	LW									
FV 112	ME						2,5	5,0	16	22
	LW									
FV 140	ME						3,0	6,0	18	26
	LW									
FV 180	ME		1420	1620	1820	2020	3,0	10,0	20	30
	LW		1341,5	1541,5	1741,5	1941,5				
FV 250	ME		1423	1623	1823	2023	3,5	11,5	26	36
	LW		1334	1534	1734	1934				
FV 315	ME		1429	1629	1829	2029	3,5	14,5	30	42
	LW		1322	1522	1722	1922				
FV 400	ME		1433	1633	1833	2033	3,5	16,5	32	44
	LW		1312	1512	1712	1912				
FV 500	ME		1435	1635	1835	2035	3,5	17,5	36	50
	LW		1304	1504	1704	1904				
FV 630	ME		1435	1635	1835	2035	4,5	17,5	42	56
	LW		1294	1494	1694	1894				